

*CONTRACTION JOINT SPACING SHALL MATCH SIDEWALK WIDTH, EXPANSION JOINTS SHALL BE SPACED TO MATCH CONTRACTION JOINT SPACING.

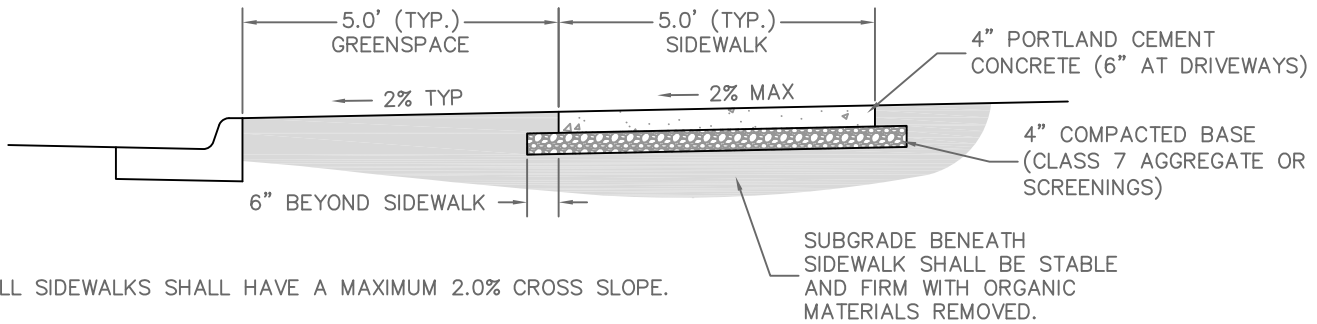

1. ALL SIDEWALKS SHALL HAVE A MAXIMUM 2.0% CROSS SLOPE.
2. ALL SIDEWALKS SHALL RECEIVE A BROOM FINISH.
3. ALL SIDEWALK EDGES SHALL HAVE A 1/2" RADIUS EDGE.
4. ALL CONCRETE SHALL BE CLASS B PER CITY'S STANDARD SPECIFICATIONS (3500 PSI, 4-7% AIR ENTRAINED). CONCRETE MAY NOT BE POURED IF A FALLING AIR TEMPERATURE FALLS BELOW 40° F NOR RESUMED UNTIL AN ASCENDING AIR TEMPERATURE RISES ABOVE 35° F WITHOUT SPECIFIC AUTHORITY FROM THE CITY REPRESENTATIVE.
5. EXPANSION JOINTS SHALL BE A MINIMUM OF 1/2" AND EXTEND THE FULL DEPTH OF THE CONCRETE. EXPANSION JOINT MATERIAL SHALL MEET AASHTO M213 FOR AN ASPHALTIC FIBER EXPANSION JOINT MATERIAL AND BE INSTALLED WITH A ZIP STRIP WHICH IS REMOVED AFTER THE CONCRETE HAS CURED AND SEALED WITH A MASTIC SEALER. OTHER ALLOWABLE EXPANSION JOINT MATERIAL ARE 1"x4" OR 2"x4" PRESSURE TREATED PINE, REDWOOD OR WESTERN RED CEDAR WITH NAILS DRIVEN THROUGH EACH SIDE TO PREVENT THE BOARD FROM BEING PUSHED OUT OF THE JOINT.
6. CONTRACTION JOINTS SHALL BE PLACED AT 5 FOOT INTERVALS.*
7. WHEN PLACING SIDEWALK AGAINST AN EXISTING CONCRETE STRUCTURE WHERE IT IS DESIRABLE THAT THE SIDEWALK REMAIN FLUSH, THE SIDEWALK SHALL BE DOWELED INTO THE STRUCTURE.
8. ALL SIDEWALK BASE SHALL BE PLACED ON FIRM, STABLE SUBGRADE.
9. CONTACT THE CITY 24 HOURS PRIOR TO POURING CONCRETE FOR AN INSPECTION.
10. CONTACT CITY FOR ACTUAL GREENSPACE AND SIDEWALK WIDTHS REQUIRED PRIOR TO BEGINNING OF CONSTRUCTION.
11. SIDEWALK AND GREENSPACE WIDTH MAY BE VARIED TO MATCH EXISTING FEATURES IF APPROVED BY THE PLANNING STAFF.

CONNECTION TO CONCRETE STRUCTURES

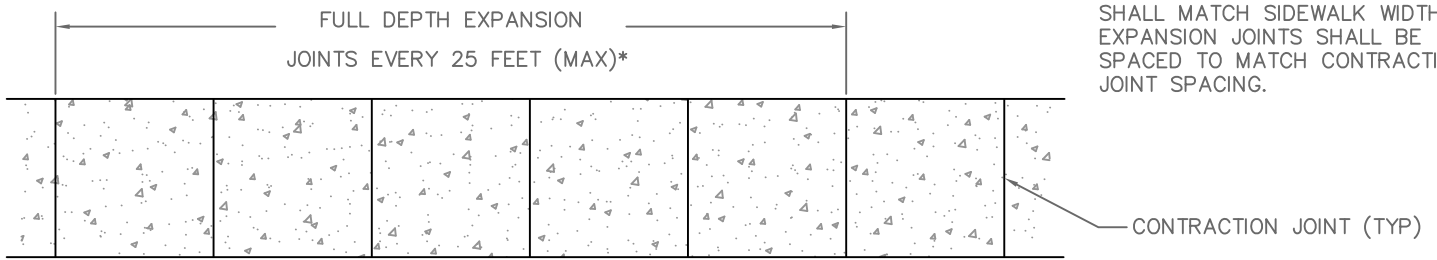
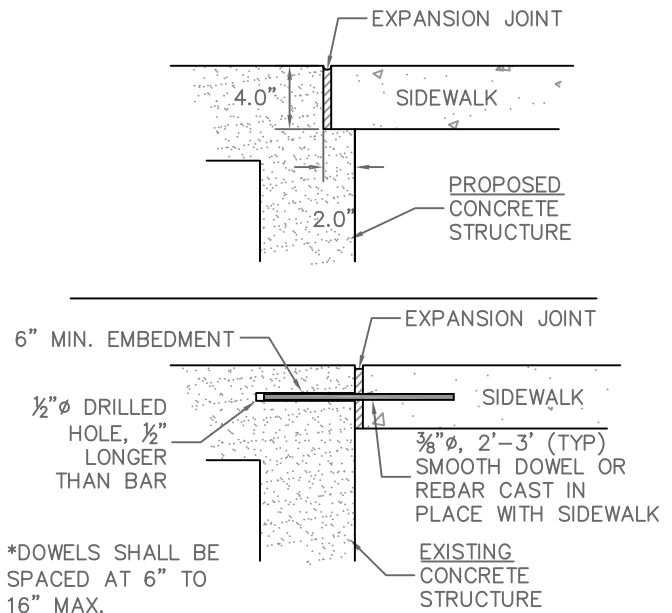

CITY OF ROGERS

301 WEST CHESTNUT STREET
 ROGERS, ARKANSAS 72756
 (479) 621-1186

TYPICAL SIDEWALK DETAILS

NOT TO SCALE

FEBRUARY 15, 2012